

**Available Lengths:**

	Hole Centre	Overall Lengths
1)	128mm	160mm
2)	160mm	200mm
3)	224mm	260mm
4)	320mm	360mm
5)	384mm	450mm
6)	632mm	670mm

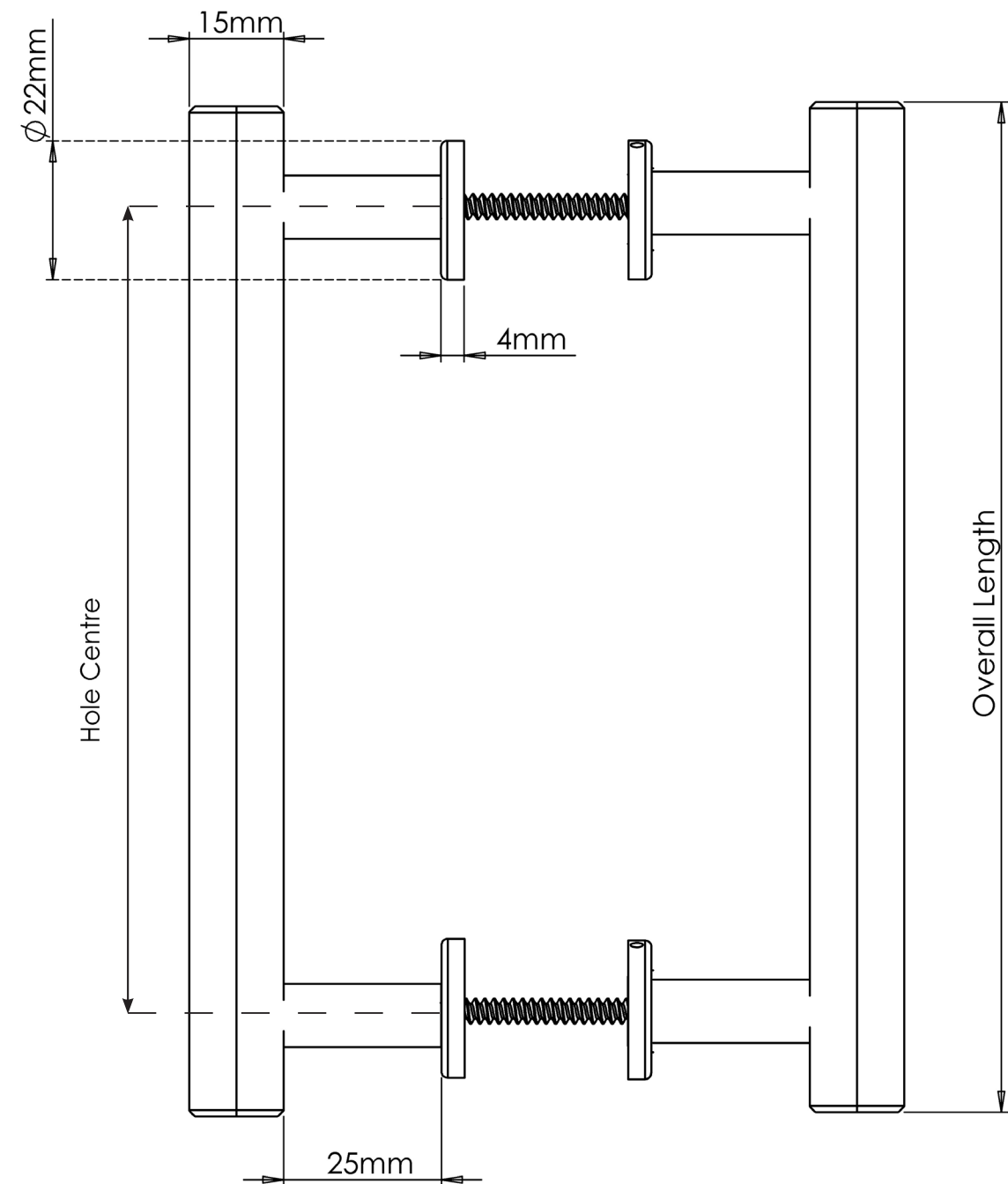

**Finishes:**

Gold  
Silver  
Black  
Antique

**Specification:**

2 x Hexagonal bar handles  
Double sided fixing  
  
Suitable for doors up to 30mm thick

**Also Included:**

2 x M4 Long Screw  
2 x Insert  
4 x M4 Grub Screw

2 x M4 Short Screw  
4 x Silicone Washer

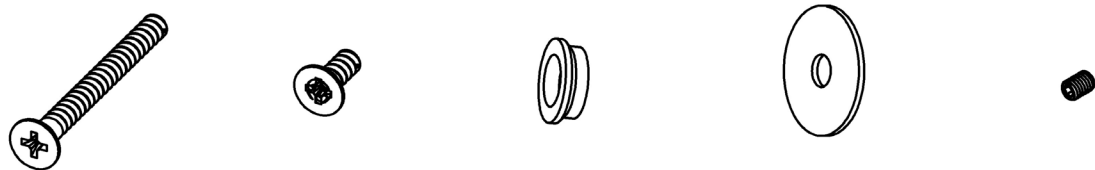

**NOTE:** All dimensions are in MM. Protective lacquer applied to prevent oxidisation and corrosion. Suitable for all appliance doors.

**CLEANING & MAINTENANCE:** Wipe clean with warm water and a soft cloth. Avoid abrasive towels, sponges, cleaning sprays and hand sanitizer

**WEIGHT:** 1) 290g 2) 350g 3) 450g  
4) 610g 5) 760g 6) 1200g

**MATERIAL:** BRASS

**SKU:** BTB01, BTB02, BTB03  
BTB04

**FINISH:** Brushed

**PUSHKA HOME**

**TITLE:** BACK TO BACK  
HANDLE