

Step 1:
Insert the spindle through the existing hole. Line up the cylinder and mark the holes.

*If the door is new, fit in your latch before drilling any holes

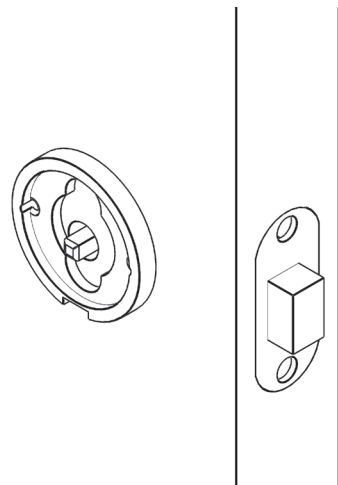

Required



Step 2:
Drill the marked holes all the way through to the other side.

Holes should be wide enough to fit the threaded tubes (5mm)

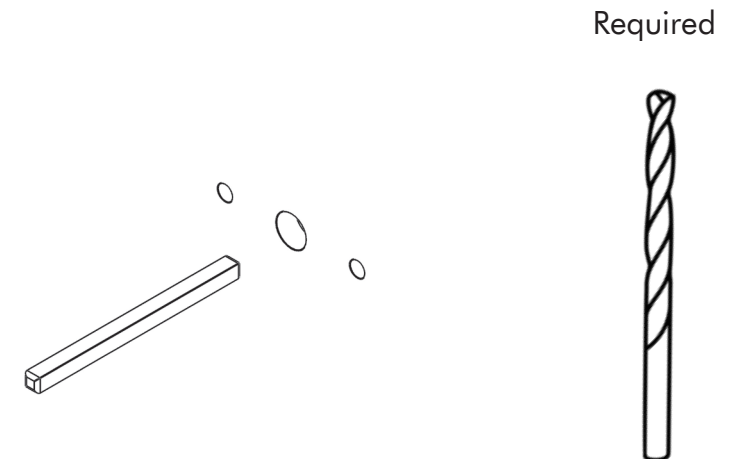

Required

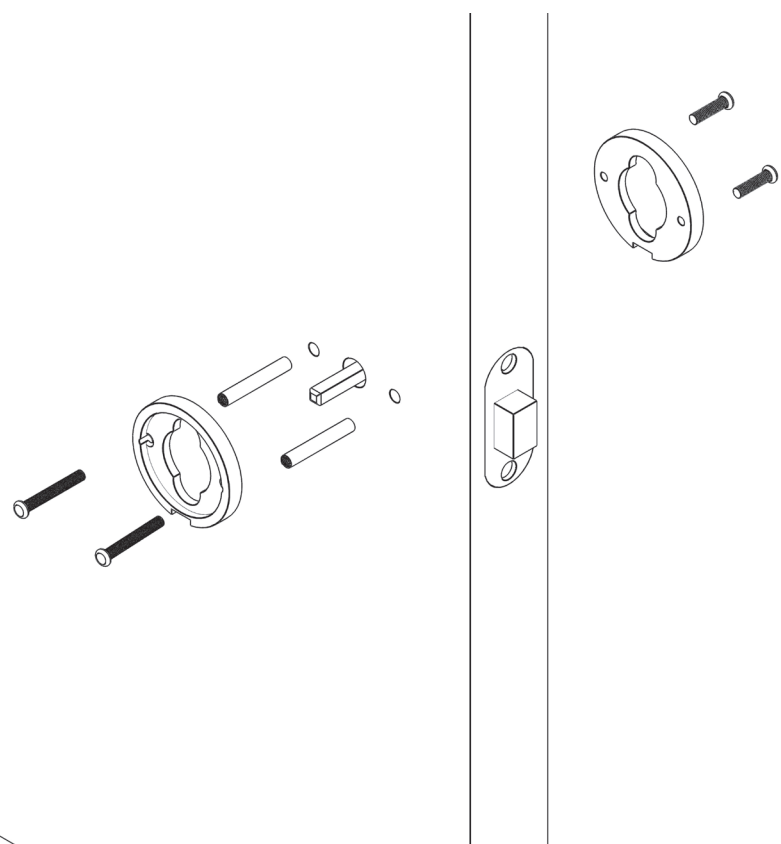

Step 3:

Insert the threaded tubes inside the holes. Follow by feeding through the 30mm machine screws through the cylinder and screwing into the threaded tubes.

The screws should be tight so that the cylinder is secured to the door and can not move.

Repeat this process on the other side and connect the two parts by feeding the 16mm machine screws into the cylinder and tighten to the threaded tubes.

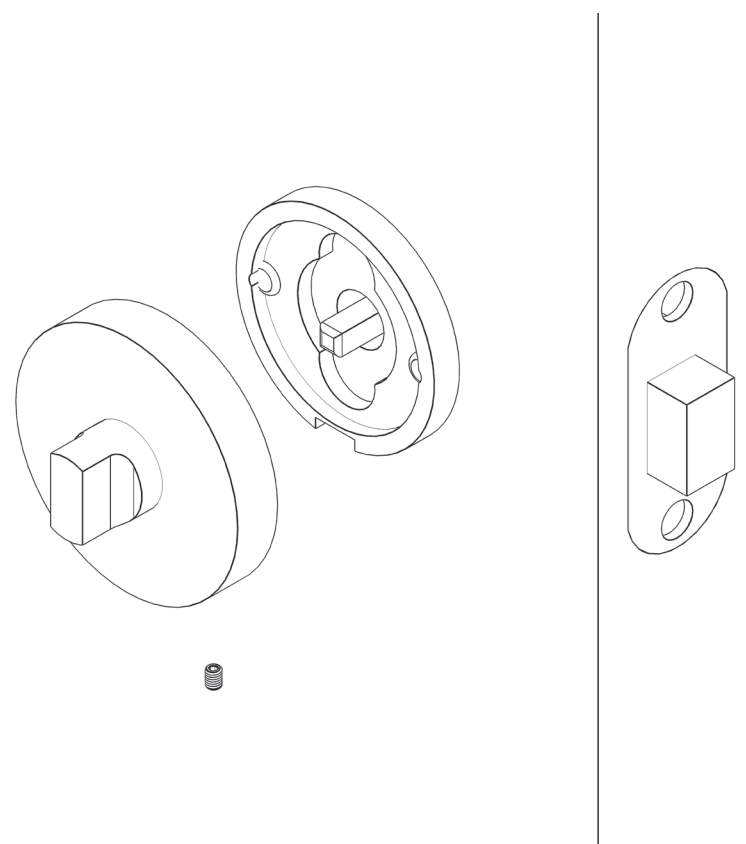

Step 4:

Slide in the external piece of the thumb turn on to the cylinder.

Ensure the spindle is all the way into the thumb turn and tighten to lock into place with the grub screws.

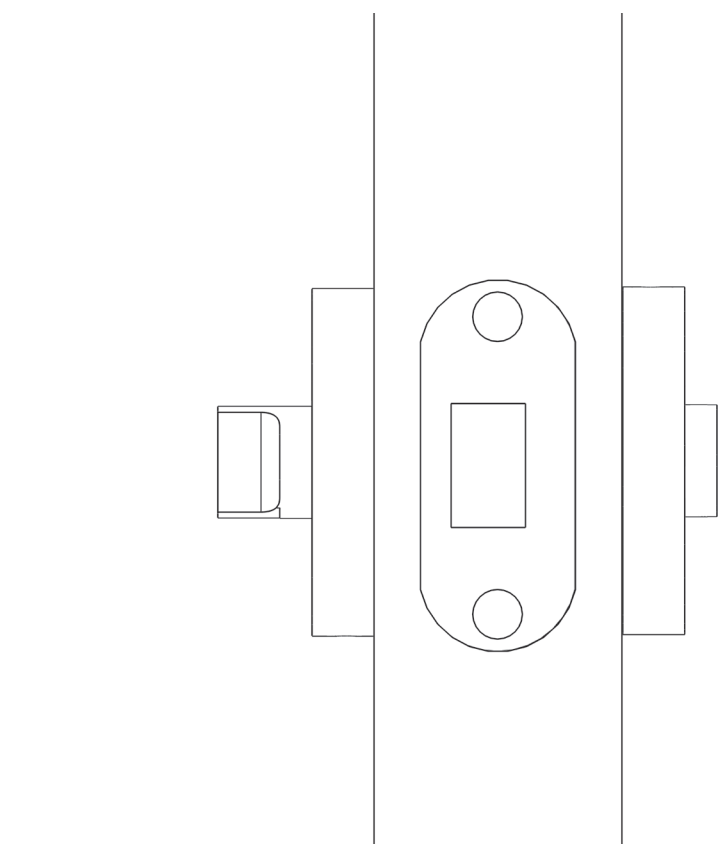

Step 5:

Repeat Step 4 on the other side to connect the two pieces of the thumb turn into place.